



# Parque Nacional de Timanfaya

## Oficinas Administrativas

C/ La Mareta, 9  
35560-Tinajo  
Lanzarote (Las Palmas)  
Tfno. 928 840 238 / 928 840 240  
Fax. 928 840 251  
timanfaya@oapn.es

## Centro de Visitantes e Interpretación de Mancha Blanca

Ctra. (LZ-67) Yaiza-Tinajo. Km. 9,600  
35560-Mancha Blanca. Tinajo  
Lanzarote (Las Palmas)  
Tfno. 928 840 839 / 928 840 831  
Fax. 928 838 235  
manchablanca@oapn.es



MINISTERIO  
DE MEDIO AMBIENTE  
Y MEDIO RURAL Y MARINO

ORGANISMO  
AUTÓNOMO  
PARQUES  
NACIONALES

Timanfaya's National Park



**Mancha Blanca Visitors  
and Interpreting Centre**





Half submerged in a sea of lava and close to **Timanfaya's National Park, Mancha Blanca Visiting and Interpreting Centre** is a welcome centre that provides information and develops interpretative activities for all the visitors to the Park. With a surface of 2,293 square meters, the Centre spreads across the main building and other adjacent structures, giving tourists the opportunity to appreciate the natural resources of the Park.



## Exhibition room

The Permanent Exhibition of **Mancha Blanca Visitors Centre** is a must-see for those who want to have a thorough knowledge of the volcanic phenomena of Timanfaya. The exhibition occupies various rooms, each equipped with different interpretative resources such as backlit panels, miniatures, interactive screens, etc. that in a simple and clear way prepare visitors for the visit to the Park. Lanzarote's Protected Areas, the internal structure of the Earth, geodynamic, volcanism and the origin of Canary Islands are some of the themes treated within the exhibition. The exhibition is also equipped with an Instrumentation Room, an element of great importance for the volcanic research activities carried out in the Park. It is also possible to see a simulation of a volcanic eruption, in which visitors can experience a situation similar to the one that the inhabitants of Lanzarote faced at the time of the last eruptions.

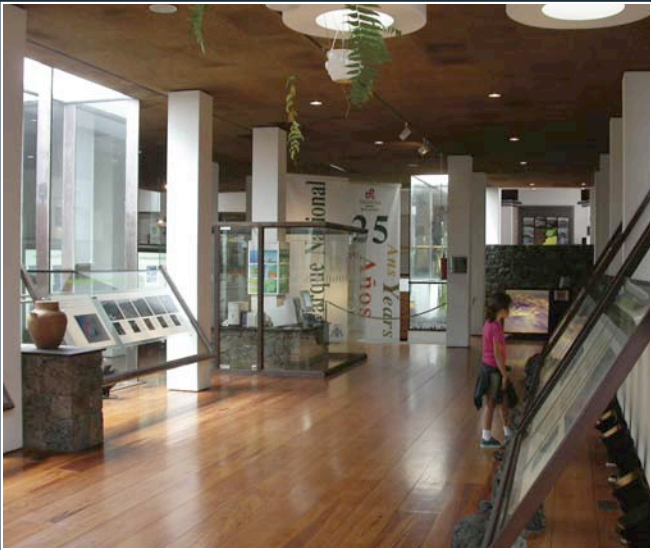

## Screening room

The Centre is equipped with a screening room with four different audiovisuales: a diaporama with an accompanying special soundtrack, a documentary on **Timanfaya's National Park** and two audiovisuales on volcanism and life in Timanfaya.



## Other facilities

**Mancha Blanca Visitors and Interpreting Centre** has a library with a complete selection of books related to **Timanfaya's National Park**, Lanzarote and the Canary Islands. The Centre has a panoramic balcony from which visitors can admire what they have previously seen in the videos and panels.

There is also a comfortable walkway with disabled access that allows visitors to submerge themselves in the volcanic flow.

**Mancha Blanca Visitors Centre** also has a bookshop, located at the entrance of the main building, and a parking area that can accommodate 57 cars and 5 buses.



## Access rules

The Centre opening hours are from 09:00am to 05:00pm all year round. For organised groups the Direction of the **Timanfaya's National Park** reserves the right to establish an advance access appointment system to the facilities in order to guarantee a homogeneous distribution of visits.

- The use of cameras is allowed for personal use only.
- No animals, with the exception of guide dogs, are allowed inside the facilities.
- Professional activities are not allowed within the Visitors Centre.
- The consumption of food or drinks, with the exception of baby food, is strictly prohibited within the Centre.

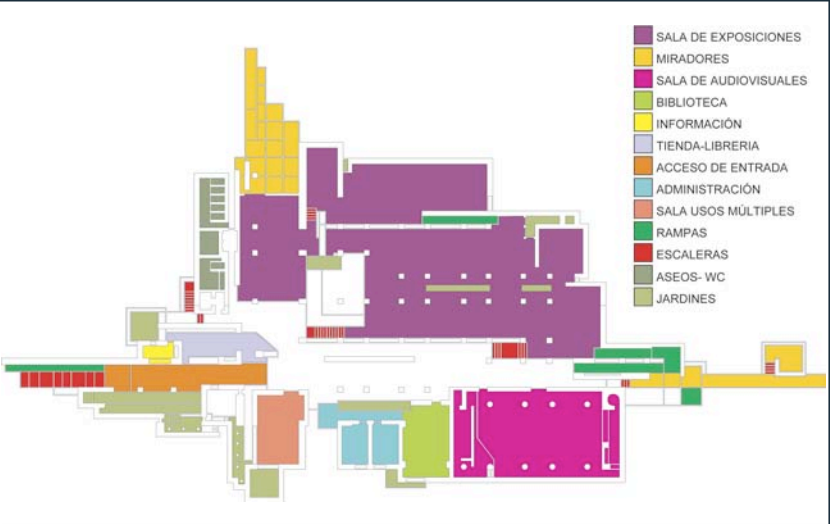

## Recommendations

In order to enjoy your visit, **Mancha Blanca Visitors and Interpreting Centre** recommends:

- In the interest of all visitors, please observe silence while visiting the exhibition.
- Do not touch anything and make appropriate use of the facilities.
- If you wish to take full advantage of the facilities, you can request a guided tour to the staff of the Centre.